

CADEL SMART 60



[Ver más información online](#)

SMART 60

Wood Insertion Cookers / Free standing wood cookers



www.forjas-salvador.com

Certificate model name : SMART 60



Nominal power	kW	6,5
Reduced power	kW	-
Introduced thermal power (max)	kW	7,7
Nominal water useful power	kW	-
Reduced water useful power	kW	-
Nominal efficiency	%	85,1
Reduced efficiency	%	-
Heating volume (min-max)	m ³	185
Nominal CO at 13% O ₂	%	0,085
Reduced CO at 13% O ₂	%	-
Emissions CO (13% O ₂) (min-max)	mg/Nm ³	1062
Emissions OGC (13% O ₂) (min-max)	mg/Nm ³	64
Emissions NOX (13% O ₂) (min-max)	mg/Nm ³	90
Dust content at 13% O ₂ (min-max)	mg/Nm ³	21
Boiler capacity (H ₂ O)	l	-
Hopper capacity	kg	-
Combustible		Legna
Hourly consumption (min-max)	kg/h	1,8
Autonomy (min-max)	h	-
Ignition electrical absorption (max)	W	-
Operating electrical absorption (max)	W	50
Supply and frequency	V - Hz	230 - 50
Chimney flue depression	Pa	12
Exhaust diameter	mm	140
Combustion air inlet diameter	mm	-
Mass of smoke (min-max)	g/sec	6,3
Exhaust fumes temperature (max)	°C	185
Net weight	kg	123
Gross weight	kg	136
Exhaust fumes	see	A
Hole combustion air inlet	see	B
Ducting outlet	see	-
Ducting capability up to	m	-

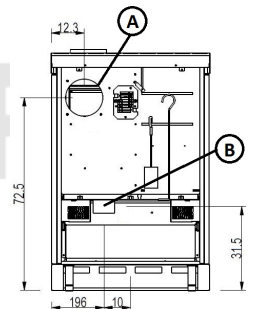
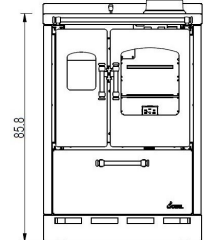
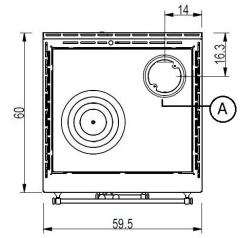

Art. 15A B-VG 2015
BImSchV 2015
Regensburg
München
Stuttgart
Aachen



MATCH

71204010	NEUTRAL STRUCTURE	EAN 8053859014669
6920002	Anthracite steel	EAN 8053859012207
6920003	White steel	EAN 8053859012214
6920004	Red steel	EAN 8053859012221
6921009	Stainless steel	EAN 8053859013884

OPTIONAL

5020005	Feet	EAN 8053859012597
5020006	Podium inox	EAN 8053859012603
5020008	H4 upstand	EAN 8053859012627
5020009	H6 upstand	EAN 8053859012634
5020014	Top	EAN 8053859012689
5021005	140/150 mm connection	EAN 8053859014256

PLUS



Cooking



Central Top and back exhaust



Refractory stone inner with 2nd combustion air



OPTIONAL
Ventilation + light kit



View on the oven



Cast iron door



Built-in



Freestanding

STOVE PACKING

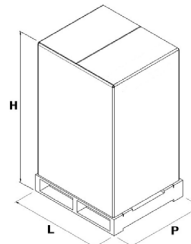

L (cm)	H (cm)	P (cm)
77	100,5	79

VOLUME (m ³)
0,61

LINING PACKING

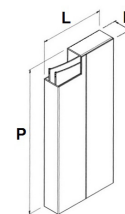

L (cm)	H (cm)	P (cm)	
steel	60	13,5	80

STOCKING

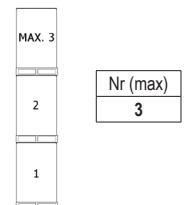

TRANSPORT

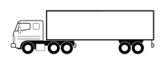

51 pcs

